

PLASTER SAWS  
AUTOPSY SAWS  
SAW BLADES  
ACCESSORIES

**dimedada**<sup>®</sup>  
SURGICAL INSTRUMENTS



# OSCILLATING SAWS

[www.dimedada.de](http://www.dimedada.de)

*cutting at the highest level*

experience & consulting  
quality & precision  
trust & perfection

*All around  
the world*



Since 1976 we have been working successfully in the medical field. The focus of all our measures and activities is the customer. His wishes, demands and requirements are a daily challenge for us. Therefore, customer service is our top priority. It effects our business policy and is a permanent task for every member of our team. For this reason we are prepared for the future at any time. Our Quality Management is an essential component in our long-term company strategy in which every single employee is involved and which is supported by a common feeling. Every Dimeda employee feels himself responsible for observance of quality no matter in which department he is working.

Our extensive warehouse guarantees quick delivery times. Articles which are not available ex stock can be supplied in a short time due to a special service. All instruments and devices of our product range are manufactured by well-trained and experienced skilled workers with special craftsmanship and by use of most modern machines and equipment.

## ELECTRONIC POWER

High Quality Oscillating Plaster Saw



### AVAILABLE MODELS

» **230 V** [30.200.20]

» **120 V** [30.200.10]

### FEATURES

- » Automatic load compensation
- » Comfortable – slim and silent motor
- » Several protection and security functions
- » Highest load capacity during continuous operation
- » Safety ON / OFF switch

### INCLUDED IN DELIVERY

- » 2 saw blades:
  - Ø 50 mm [30.210.50]
  - Ø 65 mm [30.210.65]
- » Pair of wrenches [30.210.02]
- » Instruction manual

### OPTIONAL

- » Storage box with inlay [30.200.98]



### TECHNICAL DATA

Supply voltage	230 V, 50 Hz or 110 V, 60 Hz
Rated power input	500 W
Oscillations per minute	3.500 – 24.000, infinitely variable motor speed
Cable	230 V version: 5 m cable with EU-plug 120 V version: 3 m cable with US-plug
Safety	Double protection isolation according to class II, medical use of type BF
Weight	1.25 kg without cable, 1.5 kg with cable

## SLIM POWER

High Quality Oscillating Plaster Saw



### AVAILABLE MODELS

» **230 V** [30.240.00]

» **120 V** [30.240.01]

### FEATURES

- » Easy and comfortable handling by a lightweight and handy design
- » Automatic load compensation
- » Comfortable – slim and silent motor
- » Several protection and security functions
- » Highest load capacity during continuous operation
- » Safety ON / OFF switch

### INCLUDED IN DELIVERY

- » 2 saw blades:
  - Ø 50 mm [30.210.50]
  - Ø 65 mm [30.210.65]
- » Pair of wrenches [30.210.02]
- » Instruction manual

### OPTIONAL

- » Storage box with inlay [30.200.98]



### TECHNICAL DATA

Supply voltage	230 V, 50 Hz or 110 V, 60 Hz
Rated power input	210 W
Oscillations per minute	10.000 – 19.000, infinitely variable motor speed
Cable	3 m cable with EU-plug
Safety	Double protection isolation according to class II, medical use of type BF
Weight	0.97 kg without cable, 1.1 kg with cable

## EASY POWER

One Handed Oscillating Plaster Saw



### AVAILABLE MODELS

- » **230 V** [30.230.23]
- » **120 V** [30.229.11]

### FEATURES

- » Excellent construction offers optimal single handed use
- » Opens plaster and plastic bandages safely
- » Especially quiet and largely maintenance free
- » Several protection and security functions
- » The oscillation of the saw blade can be set exactly

### INCLUDED IN DELIVERY

- » 2 saw blades:
  - Ø 65 mm [30.235.01]
  - Ø 65 mm for synthetic dressings [30.235.02]
- » Hexagonal key no. 5 [30.235.05]
- » Instruction manual
- » Optional saw blades:
  - Ø 50 mm [30.235.11]
  - Ø 50 mm for synthetic dressings [30.235.12]

### OPTIONAL

- » Storage box with inlay [30.200.98]



TECHNICAL DATA	
Supply voltage	230 V, 50 Hz or 120 V, 60 Hz
Rated power input	180 W
Oscillations per minute	12.000 – 21.000, infinitely variable motor speed
Cable	5 m cable with EU-plug
Safety	Double protection isolation according to class II, medical use of type BF
Weight	1.1 kg

## ELECTRONIC POWER

High Quality Plaster Saw with Vacuum Dust Collector

### AVAILABLE MODELS

- » **230 V** [30.222.22]
  - Consists of saw [30.200.20] and vacuum dust collector [30.222.13]
- » **120 V** [30.222.11]
  - Consists of saw [30.200.10] and vacuum dust collector [30.222.12]

### FEATURES

- » Automatic load compensation
- » Comfortable – slim and silent motor
- » Cleaner automatically turns ON/OFF along with the plaster saw
- » Cleaner turns off 6-10 sec later than the saw, hence cleaning the whole system

### INCLUDED IN DELIVERY

- » Complete with Plaster Saw “ELECTRONIC SAW”
- » 2 saw blades:
  - Ø 50 mm [30.210.50]
  - Ø 65 mm [30.210.65]
- » Pair of wrenches [30.210.02]
- » Instruction manual



### TECHNICAL DATA OF THE VACUUM DUST COLLECTORS

	30.222.13	30.222.12
Supply voltage	230 V~, 50 Hz	120 V~, 60 Hz
Continuous power	400 – 750 W	500 – 1.050 W
Max. power output	900 W PT	1.200 W PT
Suction power	Max. vacuum 2.300 mm / H <sub>2</sub> O	Max. vacuum 2.800 mm / H <sub>2</sub> O
Airflow	52 liter / second	60 liter / second
Cable	3 m cable with EU-plug	3 m cable with US plug
Energy label	Efficiency class A	

# AUTOPSY

High Quality Oscillating Autopsy Saw



## AVAILABLE MODELS

- » **230 V** [33.340.00]
- » **120 V** [33.340.01]

## FEATURES

- » Used in pathology departments for autopsy (post-mortem)
- » Saw head can be removed and steam sterilized
- » Fully automatic load-compensation
- » Comfortable – slim and silent motor
- » Safety ON / OFF switch

## INCLUDED IN DELIVERY

- » Autopsy saw blades:
  - Ø 65 mm [30.213.65]
  - Ø 65 mm [30.210.65]
  - Ø 50 mm [30.210.50]
- » Pair of wrenches [30.210.02]
- » Hexagonal key [33.341.98]
- » Instruction manual

## OPTIONAL

- » Storage box with inlay [30.200.98]



# AUTOPSY SAW LONG SHAFT

High Quality Oscillating Autopsy Saw, Triangular Saw



## AVAILABLE MODELS

- » **230 V** [33.342.00]
- » **120 V** [33.342.01]

## FEATURES

- » Used in pathology departments for autopsy (post-mortem)
- » Saw head can be removed and steam sterilized
- » Special triangular chuck for lot of arbors with different saw blades
- » Fully automatic load-compensation
- » Comfortable – slim and silent motor
- » Safety ON / OFF switch

## INCLUDED IN DELIVERY

- » Autopsy saw blades:
  - Ø 65 mm [30.213.65]
  - Ø 65 mm [30.210.65]
  - Ø 50 mm [30.210.50]
- » Short shaft [33.343.20]
- » Key #14 [33.341.97]
- » Hexagonal key [33.341.98]
- » Instruction manual

## OPTIONAL

- » Storage box with inlay [30.200.98]



## TECHNICAL DATA

Supply voltage	230 V, 50 Hz or 120 V, 60 Hz
Rated power input	500 W
Oscillations per minute	3.500 – 24.000, infinitely variable motor speed
Cable	230 V version: 5 m cable with EU-plug 120 V version: 3 m cable with US-plug
Safety	Double protection isolation according to class II, medical use of type BF
Weight	1.25 kg without cable, 1.5 kg with cable

## TECHNICAL DATA

Supply voltage	230 V, 50 Hz or 120 V, 60 Hz
Rated power input	500 W
Oscillations per minute	3.500 – 24.000, infinitely variable motor speed
Cable	230 V version: 5 m cable with EU-plug 120 V version: 3 m cable with US-plug
Safety	Double protection isolation according to class II, medical use of type BF
Weight	1.25 kg without cable, 1.5 kg with cable

# SAW BLADES

For Plaster & Autopsy Saws



Diameter / Cutting Edge (mm)	For normal plaster and autopsy	Only for synthetic casts	PTFE (non-stick) coated
45	30.210.45	30.211.45	
50	30.210.50	30.211.50	30.212.50
65	30.210.65	30.211.65	30.212.65



Diameter / Cutting Edge (mm)	For normal plaster and autopsy	Only for synthetic casts	PTFE (non-stick) coated
65	30.213.65	30.214.65	

post mortem



Diameter / Cutting Edge (mm)	For normal plaster and autopsy	Only for synthetic casts	PTFE (non-stick) coated
65	30.215.65	30.216.65	

segmented



Diameter / Cutting Edge (mm)	For normal plaster and autopsy	Only for synthetic casts	PTFE (non-stick) coated
8	30.217.17	30.217.18	
20	30.217.06	30.217.11	

depth saw



**30.218.17**

Eccentric disc to limit depth of cut

## IMPORTANT

To avoid cross-contamination, please do not reuse saw blades in forensic autopsies or tissue/organ transplantation operations.

# SAW BLADES & ACCESSORIES

For Autopsy Saw Long Shaft



**33.343.00**

Saw blade, autopsy Ø 65 mm [30.213.65]  
with short triangular shaft [33.343.20]

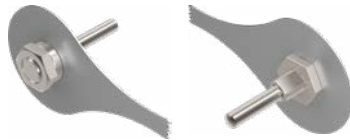

**33.343.02**

Saw blade, depth 20 mm [30.217.06]  
with short triangular shaft [33.343.20]



**33.343.13**

Saw blade, round Ø 65 mm [30.210.65]  
with eccentric disk [30.218.17]  
and short triangular shaft [33.343.20]



**33.343.20**

Triangular shaft, short, 39 mm

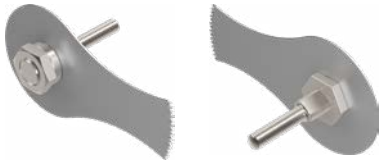

**33.343.04**

Saw blade, depth 8 mm [30.217.17]  
with short triangular shaft [33.343.20]



**33.343.10**

Double saw blades, round Ø 50 mm  
Upper Blade [30.210.50]  
Lower Blade [33.343.12]  
with long triangular shaft [33.343.21]

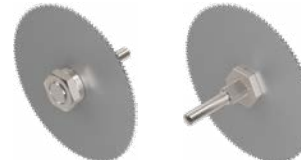

**33.343.30**

Saw blade, round Ø 65 mm [30.210.65]  
with short triangular shaft [33.343.20]



**33.343.21**

Triangular shaft, long, 58 mm  
(only for double saw)

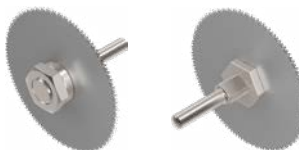

**33.343.11**

Saw blade, round Ø 50 mm [30.210.50]  
with short triangular shaft [33.343.20]

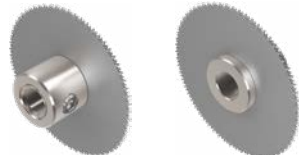

**33.343.12**

Adjustable saw blade, round Ø 50 mm,  
for double saw



**33.343.32**

Saw blade, segmented Ø 65 mm  
[30.215.65]  
with short triangular shaft [33.343.20]



**DIMEA Instrumente GmbH**

Gänsäcker 54 + 58

78532 Tuttlingen

Germany

Phone +49 7462 9461-0

Fax +49 7462 9461-33

E-Mail [info@dimea.de](mailto:info@dimea.de)

[www.dimea.de](http://www.dimea.de)