

CE  
0086



# Instructions for use



## Pouch Sealer

# Instructions for use

Please read these instructions before using the device.

Keep these "Instructions for use" in a safe place close by the unit for future reference.

**UK Customer care line:** 01254 844 116

**E-mail:** [customerservice@prestigemical.co.uk](mailto:customerservice@prestigemical.co.uk)

The Prestige Medical Customer Service Team is available to provide advice and assistance during normal office hours. To avoid delays when making contact, please have the unit's Model and Serial Numbers at hand.

**For additional information visit**  
**[www.prestigemical.co.uk](http://www.prestigemical.co.uk)**

## UK Customers

Prestige Medical Limited  
East House, Duttons Way,  
Shadsworth Business Park,  
Blackburn BB1 2QR

## Overseas Customers

Contact your local distributor. In case of doubt contact Prestige Medical Ltd

Tel: +44 (0) 1254 682 622  
Fax: +44 (0) 1254 682 606

[www.prestigemical.co.uk](http://www.prestigemical.co.uk)  
[sales@prestigemical.co.uk](mailto:sales@prestigemical.co.uk)



**Prestige Medical**  
Integrated Decontamination Solutions



BS EN ISO 9001 2000 | ISO 13485 2003  
Cert No FM31988 | Cert No FM79156

Model

Rating Plate

Serial Number

Date of purchase \_\_\_\_/\_\_\_\_/\_\_\_\_

## Prestige Medical Limited

East House, Duttons Way, Shadsworth Business Park, Blackburn, BB1 2QR

Tel : +44 (0) 1254 682 622 - Fax : +44 (0) 1254 682 606

[www.prestigemical.co.uk](http://www.prestigemical.co.uk) - [sales@prestigemical.co.uk](mailto:sales@prestigemical.co.uk)

Registered in England

Reg No. 2826793

# Contents

<b>Section</b>	<b>Page</b>
1: INTRODUCTION.....	4
FORWARD .....	5
PRESTIGE MEDICAL POUCH SEALER.....	5
SPECIFICATION.....	6
INSTRUMENTS.....	7
2: INSTALLATION.....	8
GENERAL CONDITIONS .....	8
WALL MOUNTING .....	9
3: OPERATION.....	10
SETUP .....	10
SEALING.....	10
4: USER MAINTENANCE.....	13
GENERAL CONDITIONS .....	13
DISPOSAL AND SCRAPPING .....	14
5: IMPORTANT SAFETY INSTRUCTIONS.....	15

## 1: INTRODUCTION

Thank you for choosing the Prestige Medical Pouch Sealer which is used to ensure loads are kept within a water tight and air tight seal for effective autoclaving and sterilization procedure. They are suitable for mainly dentists, beauticians, podiatrists and in certain medical or laboratory settings.

Please read these instructions for use before operating the unit and keep this manual for reference.



- |   |              |   |             |   |             |
|---|--------------|---|-------------|---|-------------|
| 1 | BLADE        | 2 | POWER CABLE | 3 | ROLL HOLDER |
| 4 | PACKET TRAY  | 5 | LED         | 6 | LEVER       |
| 7 | CUTTING TOOL |   |             |   |             |

\*Please note - sealing bags are not included

## FORWARD

The operator is liable for reading the operating manual and complying with its instructions. Prestige Medical is not liable for any damage to people or things or to the unit should the operator not comply with the operating conditions.

Such instructions are confidential and the customer is liable not to disclose any information to third parties. Such operating instructions and its annexes shall not be changed, tampered, modified, violated, copied or sold to anybody without Prestige Medical approval.

## PRESTIGE MEDICAL POUCH SEALER

- Fast & Practical Operation
- Compact Design
- Automatic Thermostat
- Seal Length 250mm
- Seal Width 12mm
- Wall Mountable



8 ON/OFF SWITCH

9 SUPPORT BRACKET

## SPECIFICATION

ITEM	VALUE	UNIT
Packet tray	Optional	
Electrical supply voltage and frequency	Volt 230 – Hz 50/60	V-Hz
Power	100	W
Length of seal	250	mm
Width of seal	12	mm
Heating	Pre-set	
Start-up	Manual	
Net Weight	6.5	kg
Seal Duration	3	Seconds
Sealing Velocity	7.5	m / minute
Dimensions		
Width	470	mm
Height	300	mm
Depth	270	mm
Packaging dimensions:		
Width	480	mm
Height	310	mm
Depth	280	mm

### Reference standards

The unit was designed in compliance with the following standards:

73/23/CE	Low voltage directive
93/68/CE	
89/336/CE	Electromagnetic compatibility directive
92/31/CE	

### Identification and marking



Name plates on the unit ARE NOT to be removed, damaged, dirtied or hidden

Technical data in the operating instructions do not replace data on the nameplates fitted onto the unit. The data name plate is fitted to the unit back.

## INSTRUMENTS

### LED

LED OUTPUT	INDICATION	ACTION
Steady green light	Apparatus ready for use	Use apparatus
Green flashing light	Heating underway	Wait till heating ends
Green light flashing with reduced frequency	ECO-mode (energy saving)	Operate the lever to return the unit to normal operation, otherwise switch the unit off.
Steady red light	Sealing has finished (where bar has been closed for 3 seconds)	Re-open sealing bar by raising lever
Red flashing light	Sealing bar broken	Replace the sealing bar

### Lever

The lever is used to operate the sealing bar. Actuating it will either engage or disengage the bar for sealing.

### Cutting tool

The cutting tool is used to operate the blade and provides a clean and easy cut once the instruments have been heat-sealed into a sealing bag.

### ON/OFF switch

The ON/OFF switch is used to switch the power on or off.

## 2: INSTALLATION

### GENERAL CONDITIONS

Before installing the pouch sealer please ensure to:

- Check that any environmental conditions are correct (explosion risk, excessively aerated areas, high humidity).
- Check that the unit is not exposed to any adverse weather conditions, such as sun, rain, wind etc.
- Check that the power supply complies with what is specified on the name plate.
- Check that the power supply is correctly grounded.

### Setting

The machine should be installed in a doctor's surgery, laboratory, dentist or similar surgery, where access is only allowed by authorised personnel.

### It must not be installed

- Near a heat source.
- In an area containing volatile or explosive substances.
- Below or above other electrical equipment in operation.
- In domestic environments or others where untrained persons have access.
- On soft or unstable surfaces or loose ground.

If the pouch sealer is to be used continuously or if heavy instruments are to be packaged it is advisable to fit the optional packet tray.

If the pouch sealer is to be installed onto a wall or cabinet please follow the instructions on the next page. Ensure suitable fixing methods are used for the type of wall (i.e. rawlplugs for brickwork, expanding anchor bolts for hollow walls).



## WALL MOUNTING

1. Using the back plate as a template; mark out the 2x holes required for mounting. Use a leveller to ensure the bracket is completely level.
2. Use a suitable fixing method for your wall type - drill a hole in the chosen wall or cabinet. Clean and insert the fixing into the hole. Expand the anchor by tightening the nut (if required). Repeat this process for the remaining hole to support the bracket. Check the fixings are secure before mounting the unit. It is advisable to use open hook expansion bolts to allow for easy installation.
3. Carefully lift the pouch sealer over the fixings to support its weight. Tighten the fixings until they are hand tight and the unit is secure.
4. Double check that the unit has secured correctly and there is no risk of it falling away from the wall or furniture.

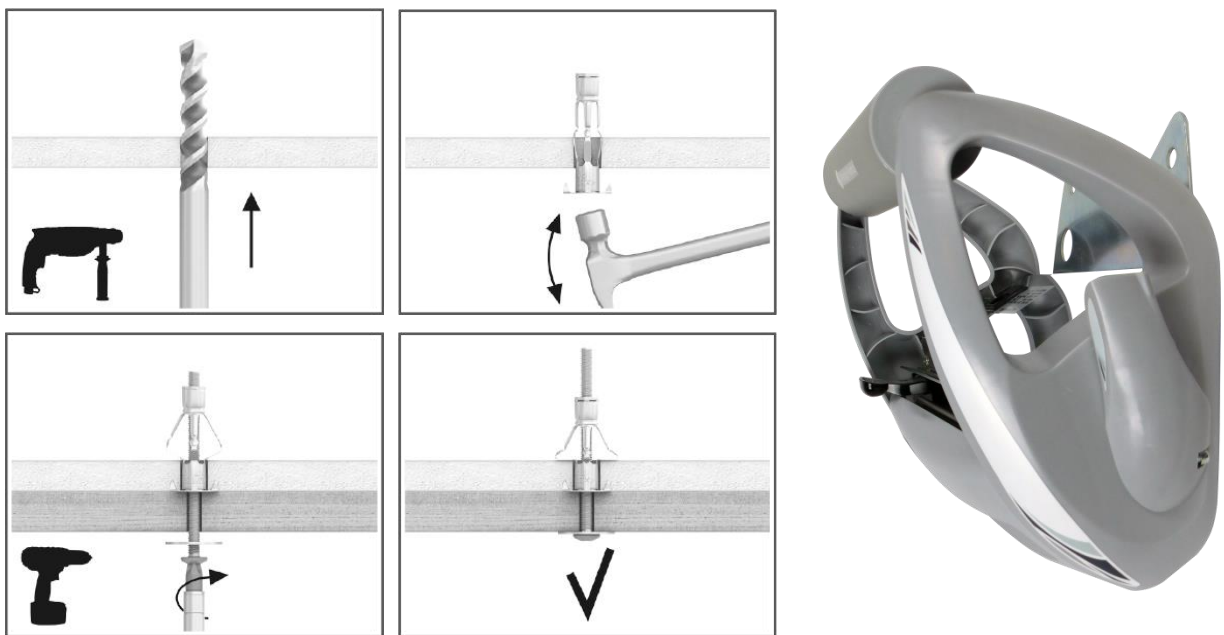

For more information on installing the Prestige Medical Pouch Sealer please contact Prestige Medical or your local distributor.

### 3: OPERATION

#### SETUP

To setup the pouch sealer plug the power cord into the power socket ensuring the ON/OFF switch is in the OFF position while you do this. Remove the roll holder from the unit by sliding it away from the user. Insert one or more rolls onto the roll holder and reinsert the holder back into its housing.



Press the ON/OFF switch to the ON position, the LED will then turn green and begin to flash. The heating element will now begin to heat up. Once the LED stops flashing after approximately 3 – 4 minutes the pouch sealer will emit a peep and the heating element will be at its required temperature; the pouch sealer is now ready for use.



Please Note - If the lever is activated before the pouch sealer has reached the required temperature, the LED will turn red and the buzzer will sound. To prevent this return the lever to the down position and wait

until the pouch sealer has reached optimum temperature.

#### SEALING

Unroll and insert the polypropylene pouch material into the rear slot of the front tray, check that the clear plastic film is face up. Pull enough of the pouch material through to fully cover the instruments that are going to be sealed. Close the sealing bar by pulling the lever to the vertical position. Manually operate the cutting tool by moving the slider from one side to the other (Making sure the sheet has fully sealed before cutting).



Once the sealing bag has been sealed it can be cut and removed from the front tray ready for the instruments to be placed inside.



**Warning: No object or instrument should be between the sealing bar and cutting tool as this could damage the heating element. Do not operate the lever without first inserting sealing bags.**

Once the sealing phase ends the LED will turn red and the buzzer will sound to signal that the sealing bar should be re-opened. If the lever is left in the down position for more than 10 seconds, the heating element will turn itself off automatically to protect the sealing bag and the components of the pouch sealer.

After each sealing cycle the pouch sealer will check its temperature and if necessary it will activate the heater to keep the heating element at the required sealing temperature.

Remove the packet created and put in the object to be sealed. Insert the open end of the packet into the front slot of the packet tray with the clear plastic film facing up.

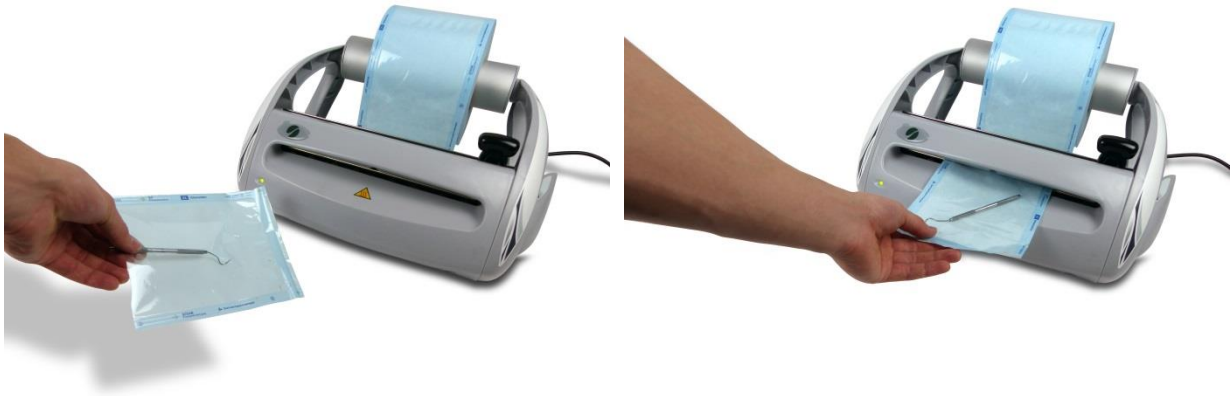

Repeat the sealing operation as before.

At the end of the operation ensure the ON/OFF switch is in the off position.

Once the sealing is finished check the seal, tugging lightly on the flaps of the packet.



If the operator has left the pouch sealer on and does not use it for at least 30 minutes, it will go into ECO-mode; the sealing bar switches off to prevent damage and energy waste. When it is in this mode the LED will flash green at a reduced frequency. To return it to normal mode, operate the lever to reactivate the heating.



The pouch sealer checks that the sealing bar is working properly. If it determines it is not, the power supply to the bar is cut off and the red LED starts flashing. The buzzer will also sound for 3 seconds.

## 4: USER MAINTENANCE

### GENERAL CONDITIONS



All maintenance is to be carried out by qualified and trained professionals only.

Maintenance is to be carried out while the unit is OFF. Please ensure there is no power being supplied to the unit and that any hot surfaces have cooled before performing any maintenance.

To avoid defective parts repairs are to be carried out with original spare parts only.



Always wear personal protective equipment.

The person responsible for the maintenance must immediately report any anomalies, scratches, fraying etc.



Do not allow that unit to be used in case of whatever problem and ask for the correct until recovery under normal conditions and in any case check that the unit conditions were recovered.

Prestige Medical will accept no responsibility when procedures recommended by our service engineers are not heeded.



In case of failures which cannot be solved please contact Prestige Medical or your local distributor.

### **Cleaning**

Clean the apparatus weekly using non-corrosive products and with the power cable disconnected.

### **Replacing the blade**

Check and/or replace the blade annually or if the blade has become blunt and cannot perform an easy cut.

## **DISPOSAL AND SCRAPPING**



Please dispose of its different parts in accordance with local laws and recycling guidelines.



ATTENTION: Prestige Medical is not liable for any damages to systems used for the operation or disposal of the unit.

## 5: IMPORTANT SAFETY INSTRUCTIONS

**WARNING** – To reduce the risk of burns, electrocution, fire or injury to persons;

Do Not:



Disassemble the pouch sealer. This should only be undertaken by an authorised service engineer.



Clean with abrasive or corrosive chemicals.



Immerse the pouch sealer in water.



Use the pouch sealer when sleepy or drowsy.

Please use the pouch sealer as instructed in this operating manual. Do not use attachments not recommended by the manufacturer



# Prestige Medical

Integrated Decontamination Solutions

Prestige Medical Limited  
East House, Duttons Way,  
Shadsworth Business Park,  
Blackburn BB1 2QR, England

Registered in England  
Reg No. 2826793  
Vat No. 633707835

Registered Office:  
c/o United Cast Bar (UK) Limited,  
Spital Lane, Chesterfield,  
Derbyshire, S41 0EX, England  
Prestige Medical is a registered trademark



Paper



Please recycle

*Due to a continuous process of development, Prestige Medical reserves the right to amend the specification of products and services without notice.*